

KEY CLAMP SYSTEM
END CAPS / PLASTIC

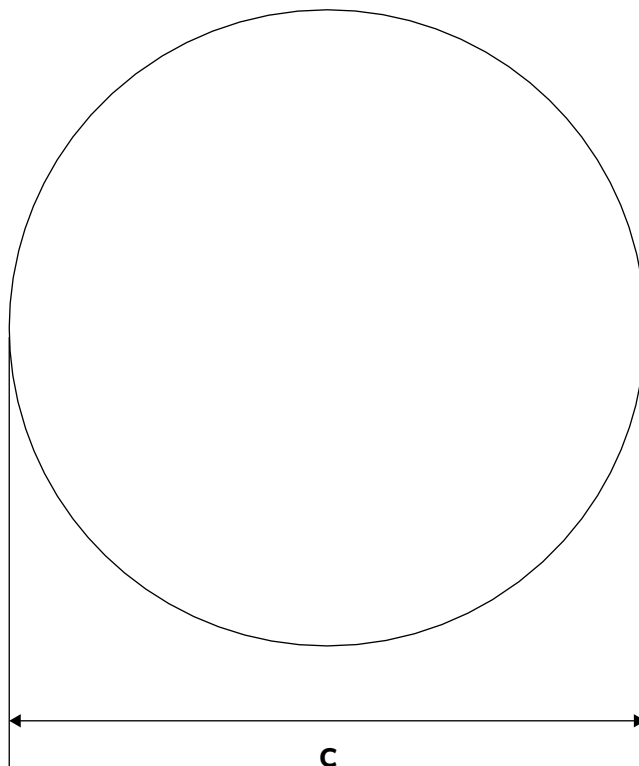

CODE	A	B	C	WEIGHT
KCS-33.7-ECP	20.6mm	135mm	34.2mm	0.01kg

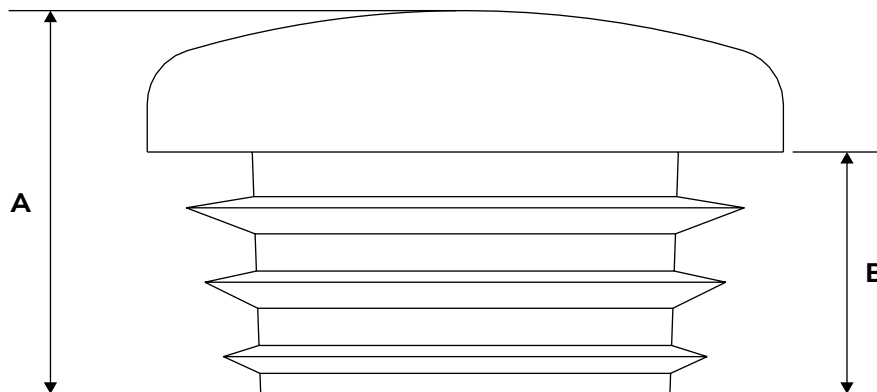

PLASTIC END CAP FOR SEALING OPEN TUBE ENDS.
 FRICTION FIT ONLY—USE A SUITABLE ADHESIVE FOR A PERMANENT FIXING.

DIMENSIONS ARE PROVIDED AS A GUIDE ONLY AND MAY VARY SLIGHTLY. DRAWING NOT TO SCALE.

WELDITNFS.COM

